

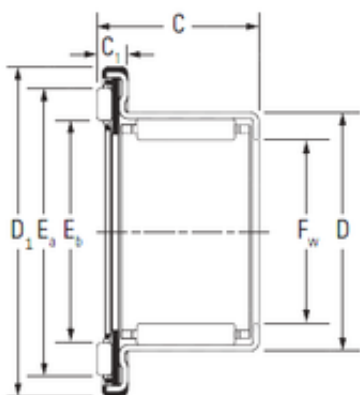

Timken RAX 745 complex bearings



Bearing No. RAX 745

Size	45x66.5x22.2 mm
Bore Diameter	45 mm
Outer Diameter	66,5 mm
Width	22,2 mm
Fw	45 mm
D	52 mm
D1	66,5 mm
C	22,2 mm
C1	4,2 mm
Ea	59,9 mm
Eb	48 mm
Weight	0,088 Kg
Dynamic load rating radial (C)	24,8 kN
Dynamic load rating axial (C)	21,8 kN
Static load rating radial (C0)	55 kN
Static load rating axial (C0)	109 kN

RAX 745 Bearing 2D drawings and 3D CAD models